

Replacement Fan Tray Instructions



for the HP ProCurve zl Switches

The fan tray is hot swappable. It can be removed and replaced without removing power from the switch. However, install the new fan tray immediately (within two minutes) after removing the old fan tray to avoid overheating and a switch shutdown (within three minutes).

1. Release the retaining screws
2. Grasp the handle and remove the old fan tray
3. Install the new fan tray
4. Tighten the retaining screws

WARNING

To avoid contact with spinning fans, if you are hot swapping out the fan tray assembly, pull the assembly out one-inch and allow the fans to stop rotating (approximately 20 seconds) before pulling it all the way out.

Example Installation of a 5400zl (for 5406zl and 5412zl) Fan Tray:

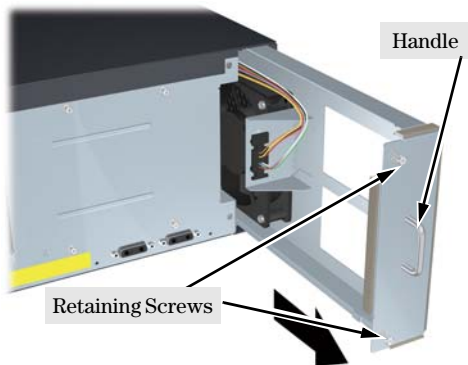

Figure 1. 5406zl Switch Fan Tray removal

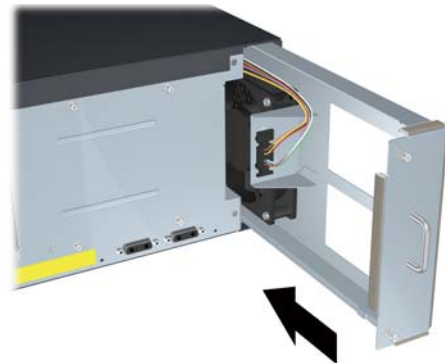

Figure 2. 5406zl Switch Fan Tray installation

Example Installation of an 8200zl (for 8206zl and 8212zl) Fan Tray:

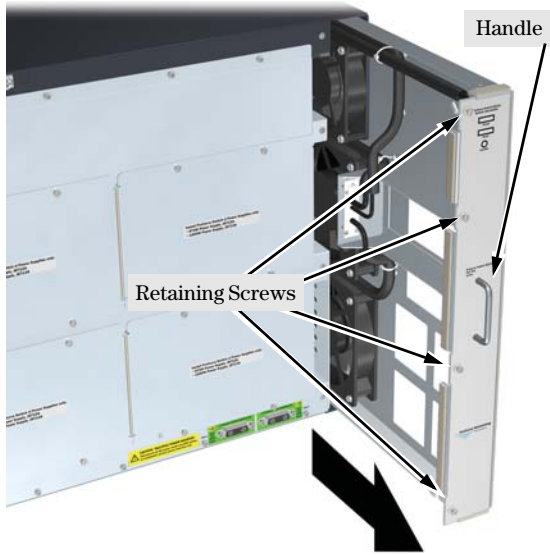

Figure 3. 8212zl Switch Fan Tray removal



Figure 4. 8212zl Switch Fan Tray installation

有毒、有害物质/元素及其含量表

依照中国
《电子信息产品污染控制管理办法》

| 部件名称 | 有毒、有害物质和元素 | | | | | |
|-----------------|------------|--------|--------|--------------|------------|---------------|
| | 铅 (Pb) | 汞 (Hg) | 镉 (Cd) | 六价铬 (Cr(VI)) | 多溴联苯 (PBB) | 多溴代二苯醚 (PBDE) |
| 机箱/隔板/其它金属和塑料部件 | 0 | 0 | 0 | 0 | 0 | 0 |
| 印刷电路组件 (PCA) | X | 0 | 0 | 0 | 0 | 0 |
| 天线 | X | 0 | 0 | 0 | 0 | 0 |
| 电缆/电线 | X | 0 | 0 | 0 | 0 | 0 |
| 电池 | 0 | 0 | 0 | 0 | 0 | 0 |
| 风扇/风扇盘 | 0 | 0 | 0 | 0 | 0 | 0 |
| 电源/电源适配器 | X | 0 | 0 | 0 | 0 | 0 |
| 安装支架/其它附件 | 0 | 0 | 0 | 0 | 0 | 0 |
| CF 卡 | 0 | 0 | 0 | 0 | 0 | 0 |

0: 表示此部件使用的所有同类材料中此种有毒或有害物质的含量均低于 SJ/T11363-2006 规定的限制要求。
X: 表示此部件使用的至少一种同类材料中, 此种有毒或有害物质的含量高于 SJ/T11363-2006 规定的限制要求。

注: 所引用的环保使用期限标记根据产品的正常操作使用条件 (如温度和湿度) 确定。



除非另有标明, 此电子信息产品污染控制标记适用于所有 ProCurve Networking by HP 产品。

This information is required by the People's Republic of China as per their legislation titled "Management Methods for Controlling Pollution by Electronic Information Products".

© Copyright 2009 Hewlett-Packard Development Company, LP. All rights reserved. The information contained herein is subject to change without notice.

This document contains proprietary information, which is protected by copyright. No part of this document may be photocopied, reproduced, or translated into another language without the prior written consent of Hewlett-Packard.

Technical information in this document is subject to change without notice.



Part Number: 5900-0220
June 2009
Printed in Singapore

